

## Section For a Maximum 700 and 900 Square Foot Detached Garage

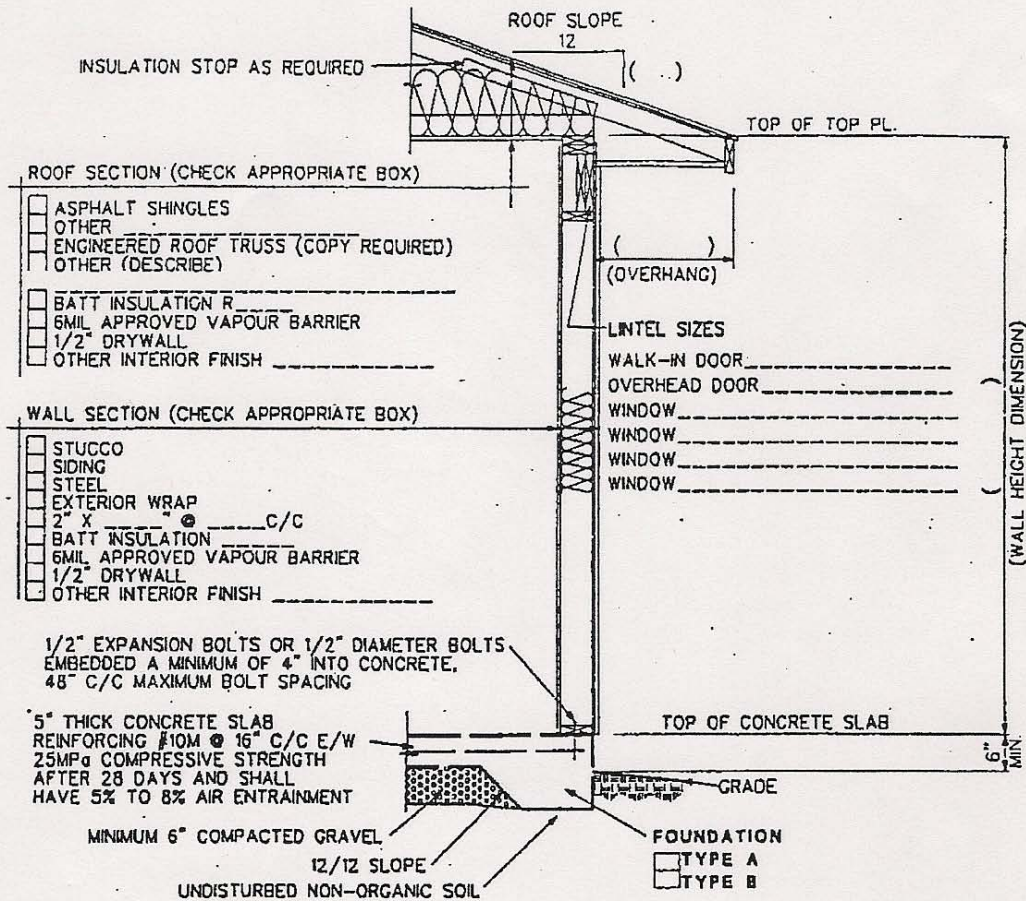

**TYPICAL WALL/ROOF SECTION**  
NOT TO SCALE

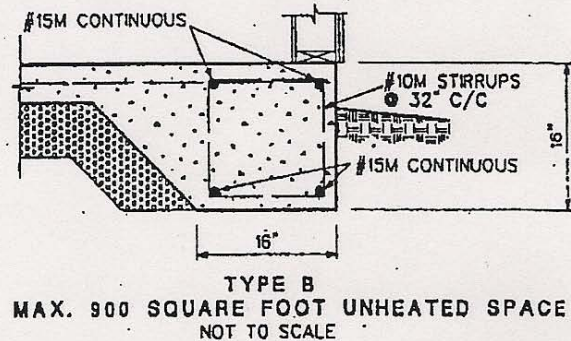
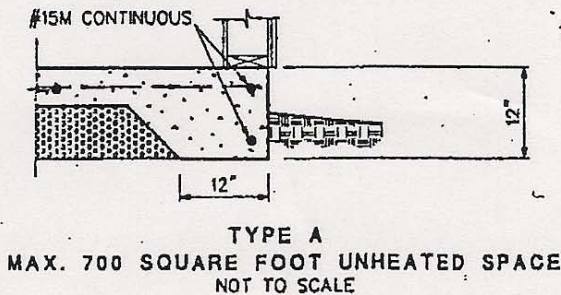

**Notes:**

- This plan shall not be used unless the plan has been approved by the Building Authority having jurisdiction.
- A copy of the prefabricators certified roof truss drawings shall be supplied.
- These foundation details may not be suitable for all soil conditions. If the soil bearing is in question, it is the responsibility of the Building Authority having jurisdiction to request that the slab be designed and certified by an Engineer.
- The reference to "P.T." means material approved for Wood Foundations, CAN/CSA-S406.
- The reinforcing shall be free from rust, mud, oil, or other coats that would reduce the bond between the concrete and the reinforcing.
- All reinforcing shall be new billet deformed bars that conform to CSA standards, #10m = 300KPa and #15 or larger = 400KPa.
- All reinforcing shall have a minimum of 2" of concrete cover.